

Proposed Cross Section Thro' Extension

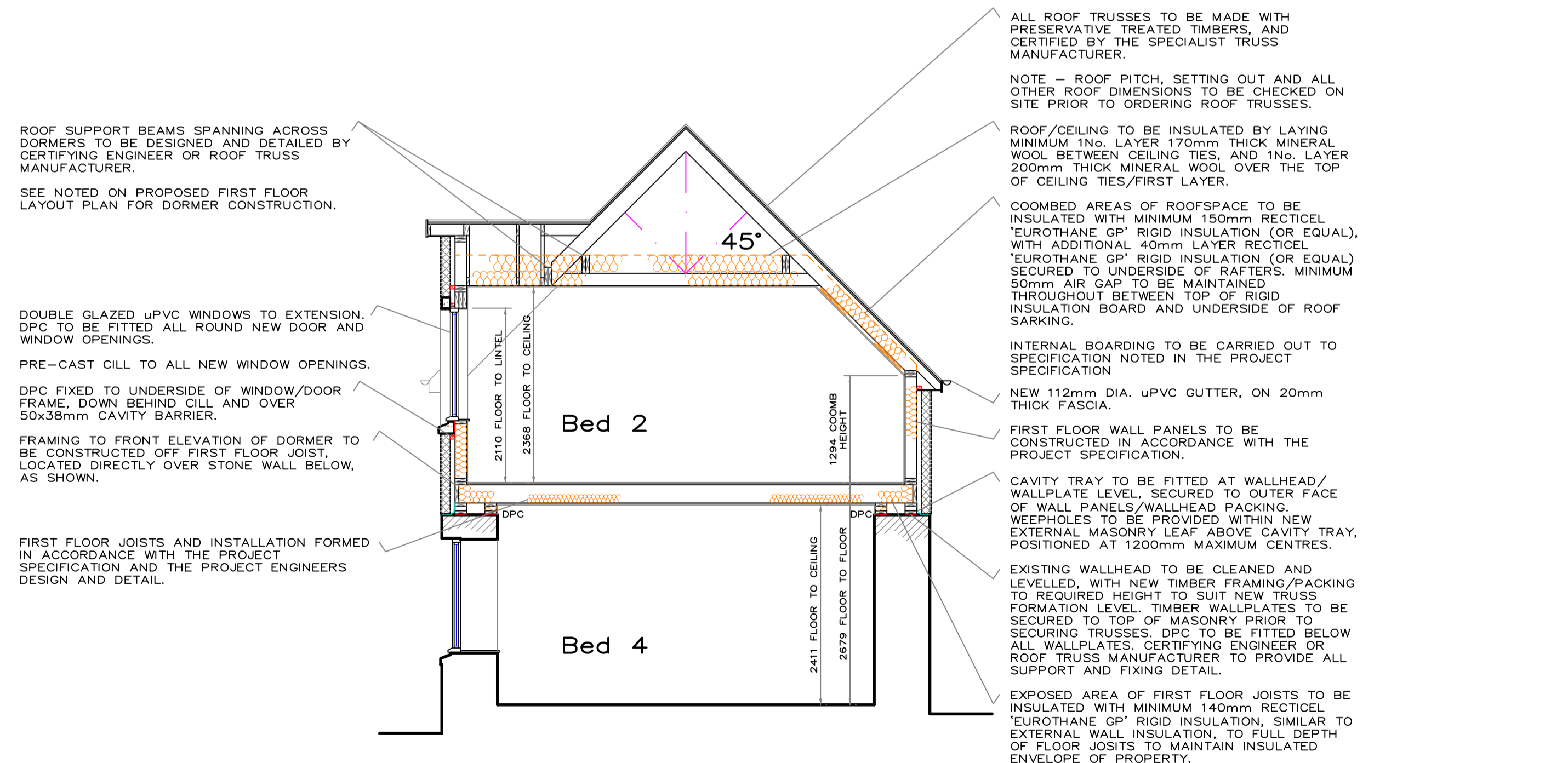

Proposed Cross Section Thro' Existing House

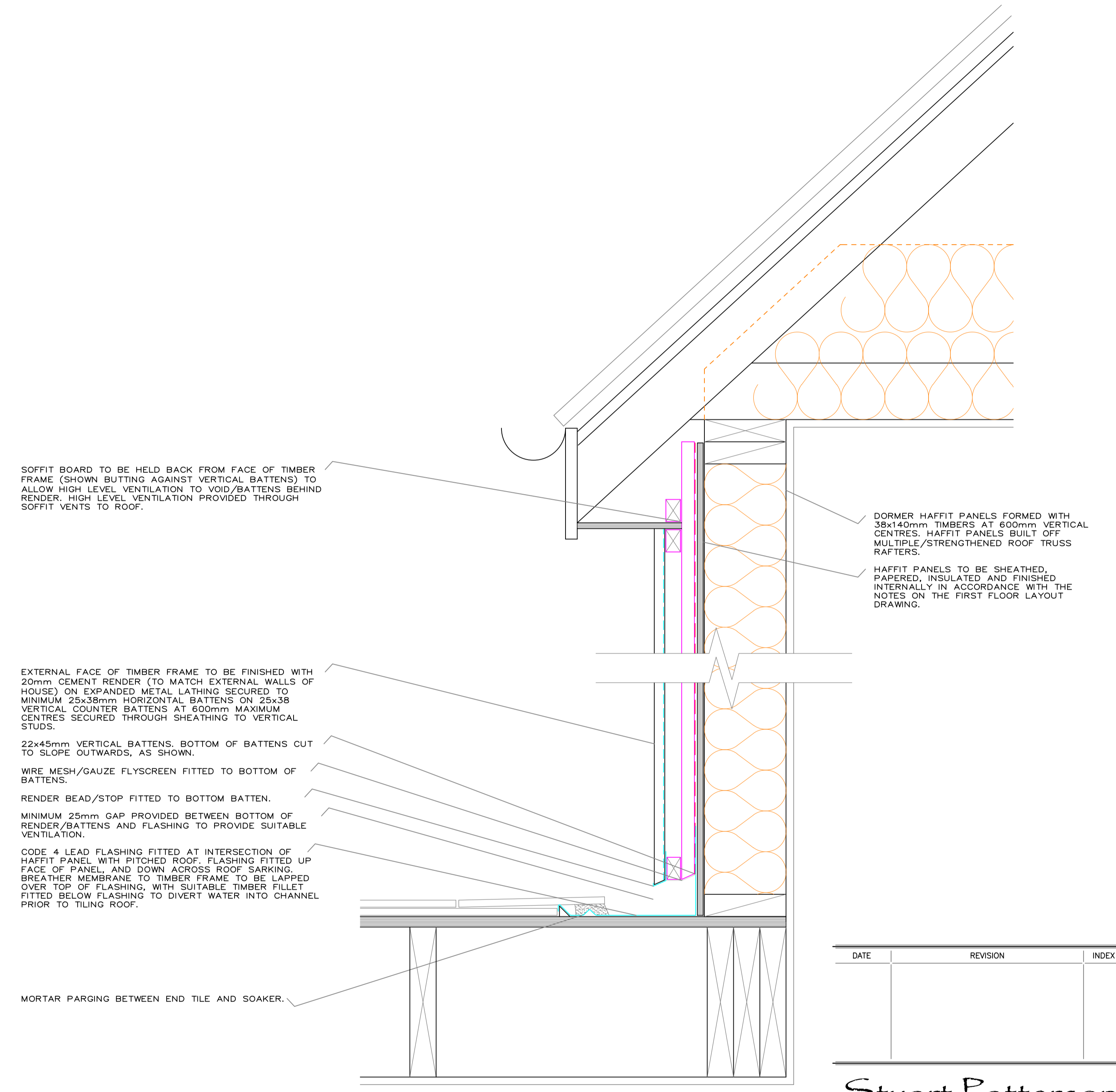

Detail Through Haffit Infill Panels
SCALE 1:5.

DATE	REVISION	INDEX

Stuart Patterson
 Building & Timber Frame Design
 3 Burnflat Lane, Hawick,
 Roxburghshire, TD9 0DZ
 phone - 01450 375772
 email - stuartpattersondesign@gmail.com

CLIENT
Mr E. Alanizi
 PROJECT
 PROPOSED EXTENSION & ALTERATION AT
 WHINFIELD COTTAGE,
 CHESTERS, HAWICK.

DRAWING TITLE
PROPOSED SECTIONS & DETAIL

SCALES
 1:50..

DATE
 14/1/21

DRAWING No.
21-714-3002

